

**DETAIL BUS STOP**  
SCALE 1/400 @ A3

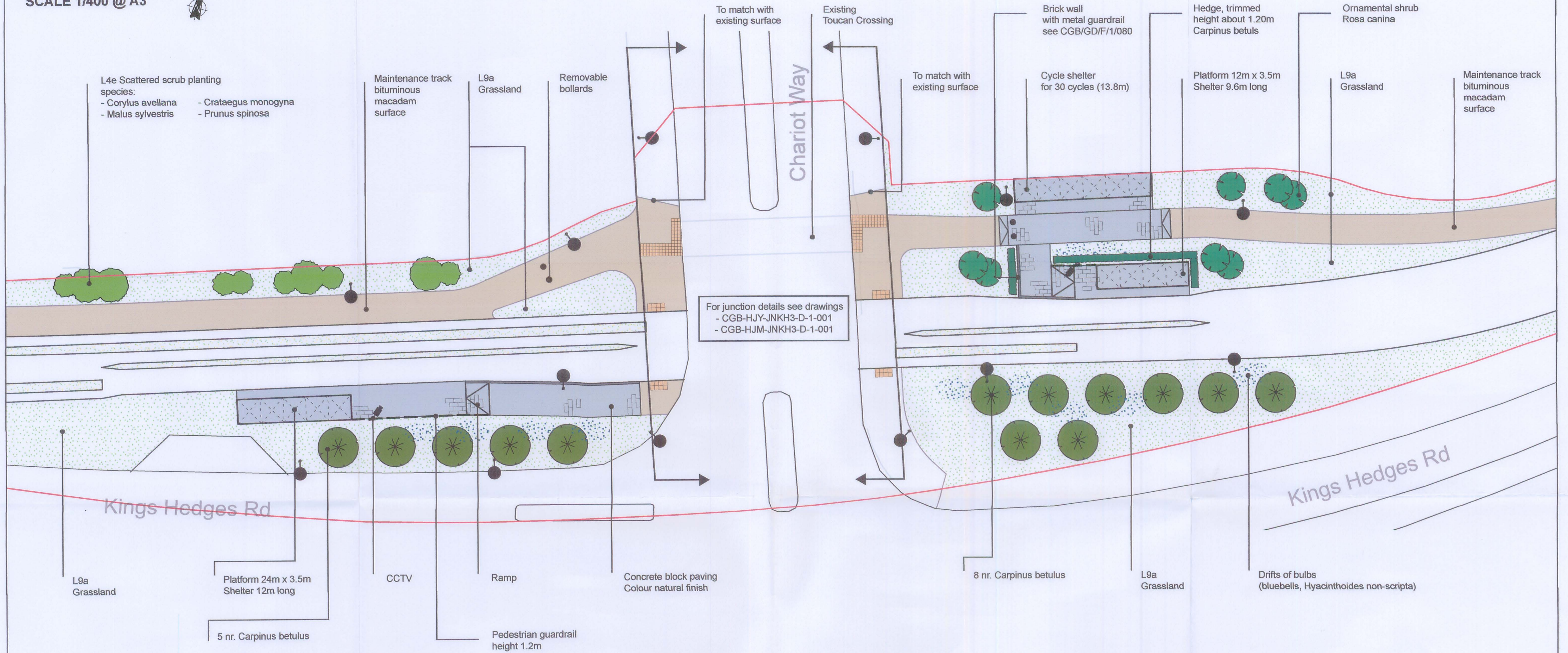

**NOTE:**  
Road marking  
'LOOK BOTH WAYS' has to be painted in with letters on the ground at all crossing points on entering the Guided Bus Way and the maintenance track  
Signage  
- 'GUIDED BUSWAY LOOK BOTH WAYS' sign, located every side of the Guided Busway crossing  
- '30 MPH & ALL CLEAR', Ø450mm sign 150m from crossing, both sides

**FOR PLATFORM SECTION SEE PLAN**  
**CGB-DES-19400-D-1-1005**

**LEGEND**

- Site Boundary
- Lighting column
- CCTV
- Pedestrian Guardrail
- Bituminous macadam
- Tactile paving
- Concrete block paving colour natural finish
- Brick wall, anthracite, English bond, height 0.4m with metal guardrail, height 0.8m

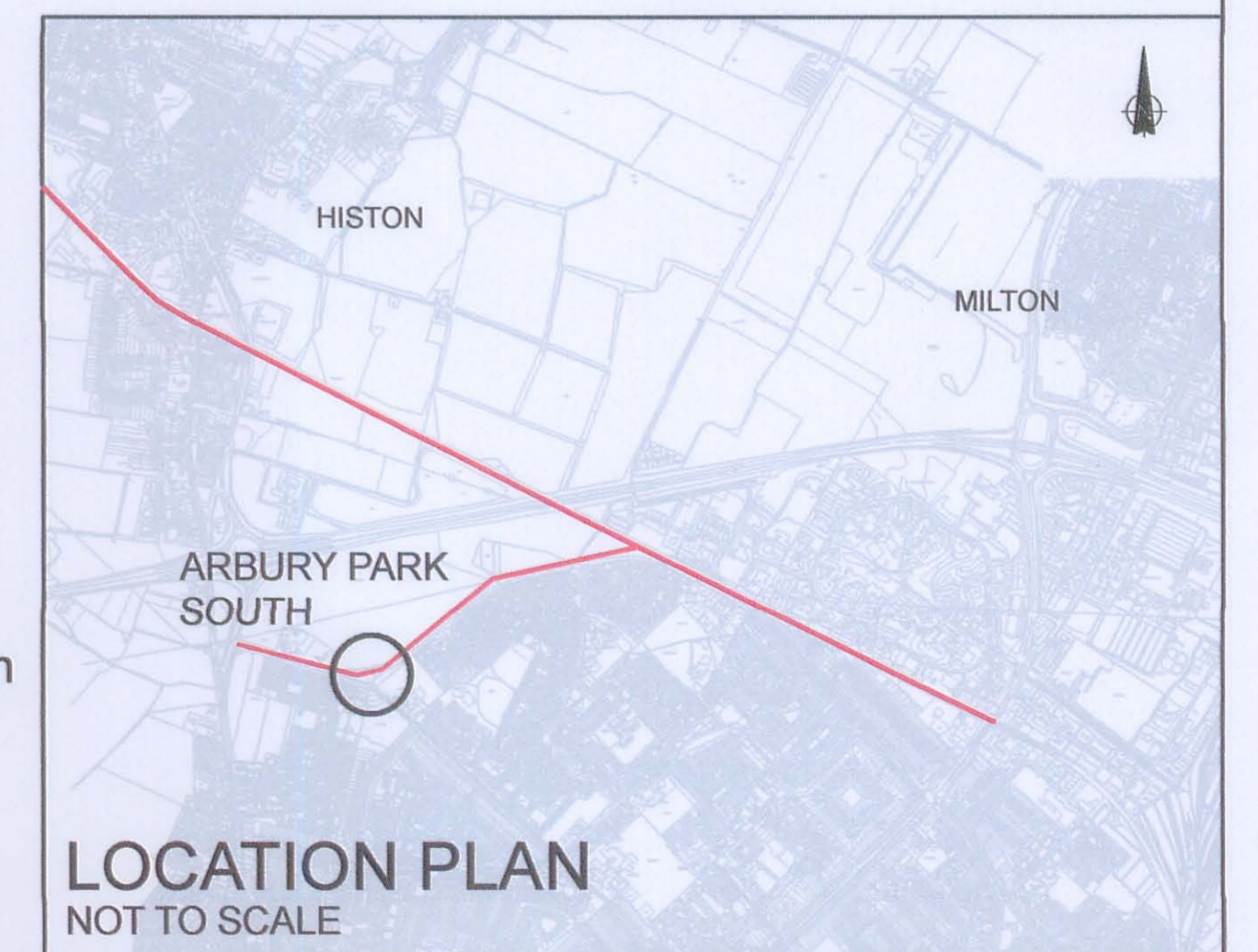

| REV | DATE     | DESCRIPTION | BY | CHKD | APPD | NOTES |
|-----|----------|-------------|----|------|------|-------|
| 0   | 14.05.08 | DRAFT       | BS | RH   | KR   |       |
| 1   | 07.08.08 | REVISION 1  | BS | MR   | KR   |       |
| 2   | 02.09.08 | REVISION 2  | BS | MR   | KR   |       |

| BY | CHKD | APPD | NOTES                   |
|----|------|------|-------------------------|
| BS | RH   | KR   | AMENDED JUNCTION LAYOUT |
| BS | MR   | KR   | AMENDED LOCATION PLAN   |
| BS | MR   | KR   |                         |

**CONTRACTOR**

**CONSULTANTS**  
CGB Design JV

**CLIENT**  
 Cambridgeshire County Council

**PROJECT**  
 CAMBRIDGESHIRE GUIDED BUSWAY

**TITLE**  
Cambridge Guided Busway  
Bus Stop Arbury Park South  
Hard and Soft Landscape Proposal

|                |                            |             |    |
|----------------|----------------------------|-------------|----|
| DATE           | 14.05.08                   | PRODUCED BY | BS |
| SCALE          | 1/400@ A3                  | CHECKED     | RH |
| CAD REF        |                            | APPROVED    | KR |
| DRAWING NUMBER | CGB.DES.80400-D-1-1011   2 |             |    |

**DETAIL BUS STOP**  
SCALE 1/400

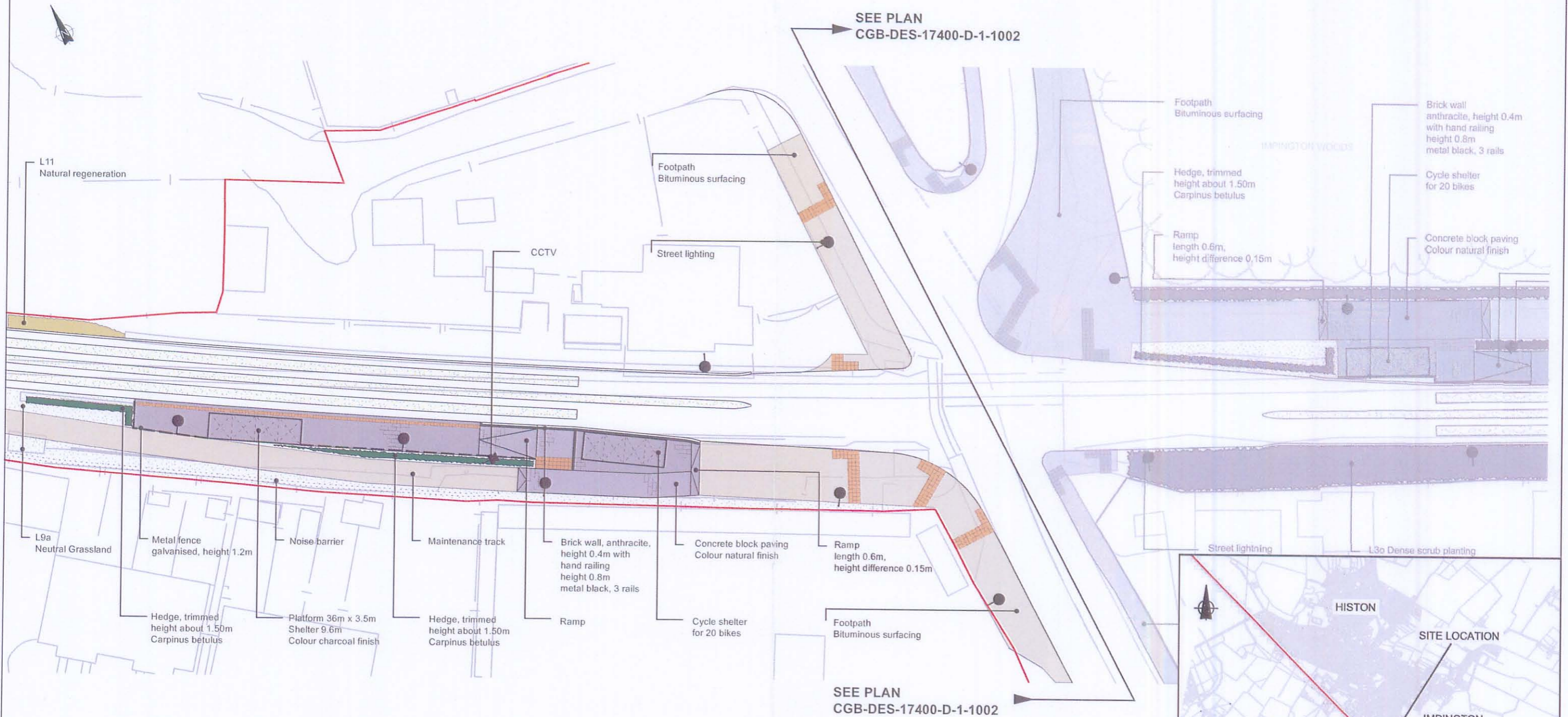

**NOTE:**  
Road marking  
'LOOK BOTH WAYS' has to be painted in with letters on the ground at all crossing points on entering the Guided Bus Way and the maintenance track  
Signage

**FOR PLATFORM SECTION SEE PLAN**  
CGB-DES-19400-D-1-1005

BASED UPON ORDNANCE SURVEY MATERIAL WITH THE PERMISSION OF THE CONTROLLER OF HER MAJESTY'S STATIONERY OFFICE © CROWN COPYRIGHT. Cambridgeshire County Council 100023305 2004

| REV | DATE     | BY | CHKD | APPD | NOTES      |
|-----|----------|----|------|------|------------|
| 0   | 13.11.07 | BS | TA   | KR   | DRAFT      |
| 1   | 12.12.07 | BS | TA   | KR   | Revision 1 |
| 2   | 11.01.08 | BS | TA   | KR   | Revision 2 |

**LEGEND**

- Site Boundary
- Lighting column
- CCTV
- Signage
- Tactile paving

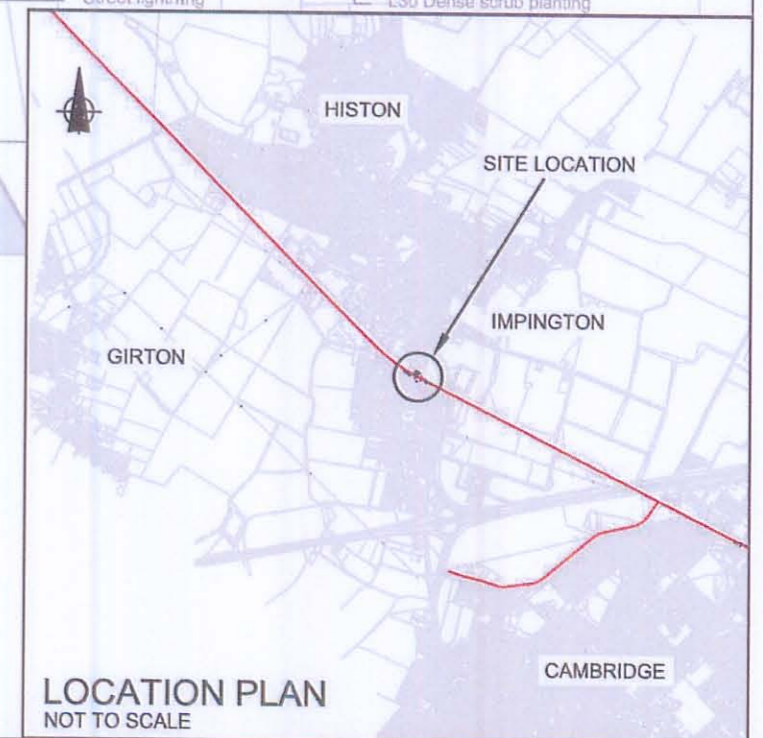

**CONTRACTOR**

**CONSULTANTS**  
CGB Design JV | |

**CLIENT**

**PROJECT**

**TITLE**  
Cambridge Guided Busway  
Bus Stop Histon & Impington  
Hard and Soft Landscape Proposals

DATE 13.11.07  
SCALE A3  
CAD REF  
DRAWING NUMBER

PRODUCED BY BS  
CHECKED TA  
APPROVED KR

**DETAIL BUS STOP  
SCALE 1/400**



SEE PLAN  
CGB-DES-17300-D-1-1001

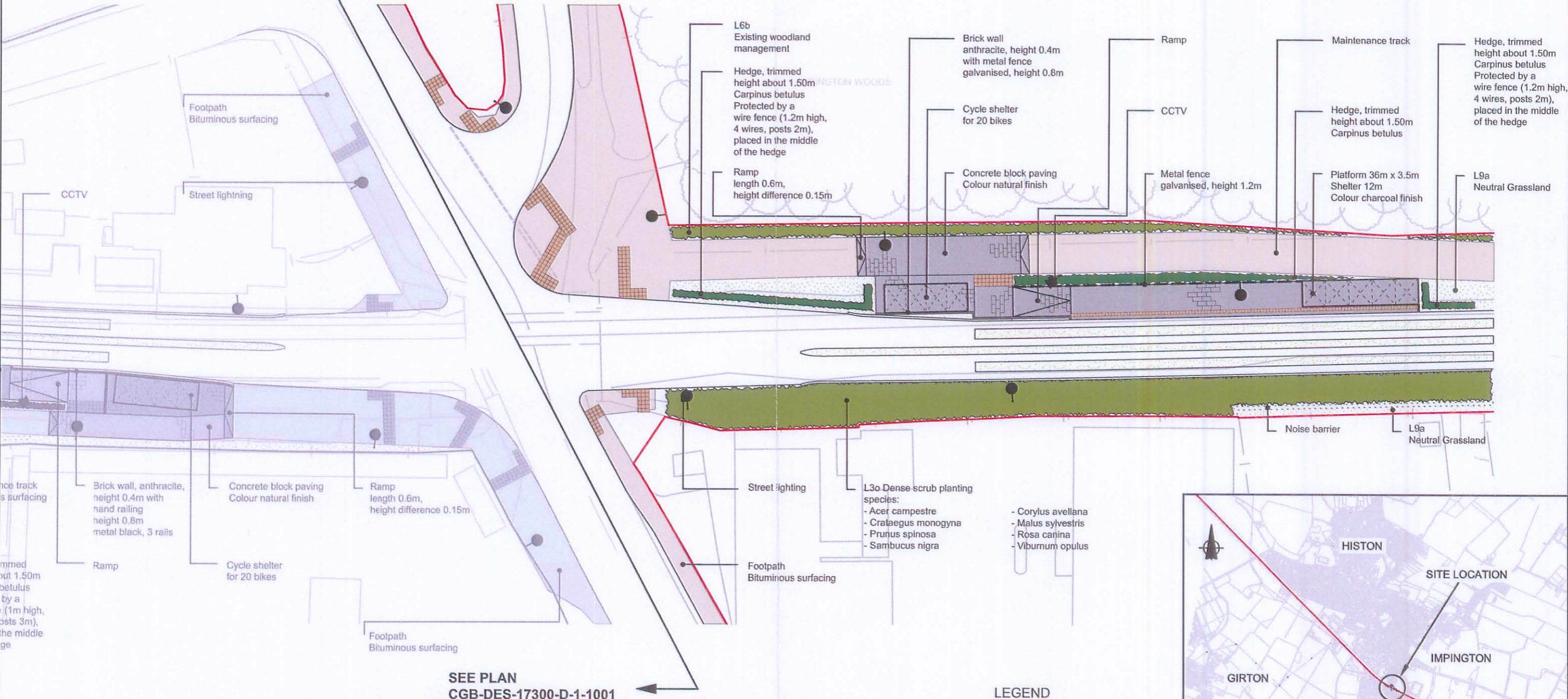

SEE PLAN  
CGB-DES-17300-D-1-1001

**NOTE:**  
Road marking  
'LOOK BOTH WAYS' has to be painted in with letters on the ground at all crossing points on entering the Guided Bus Way and the maintenance track  
Signage

**FOR PLATFORM SECTION SEE PLAN  
CGB-DES-19400-D-1-1005**

BASED UPON ORDNANCE SURVEY MATERIAL WITH THE PERMISSION OF THE CONTROLLER OF HER MAJESTY'S STATIONERY OFFICE  
© CROWN COPYRIGHT. Cambridgeshire County Council 100023205 2004

| REV | DATE     | BY | CHKD | APPD | NOTES      |
|-----|----------|----|------|------|------------|
| 0   | 13.11.07 | BS | TA   | KR   | DRAFT      |
| 1   | 12.12.07 | BS | TA   | KR   | Revision 1 |
| 2   | 11.01.08 | BS | TA   | KR   | Revision 2 |

**CONTRACTOR**  
 nuttall

**CONSULTANTS**  
 CGB Design JV ARUP

**CLIENT**  
 Cambridgeshire County Council

**PROJECT**  
 CAMBRIDGESHIRE GUIDED BUSWAY

**TITLE**  
 Cambridge Guided Busway  
 Bus Stop Histon & Impington  
 Hard and Soft Landscape Proposals

**DATE** 13.11.07 **PRODUCED BY** BS  
**SCALE** A3 **CHECKED** TA  
**DRAWING NUMBER** CGB.DES.17400-D-1-1002 | 2

**LEGEND**

- Site Boundary
- Lighting column
- CCTV
- Signage
- Tactile paving



C:\CAMB\17300\17300-D-1-1002.dwg 11/12/2007 10:20:00 13/11/2007 - 13/11/2007 - 13/11/2007